

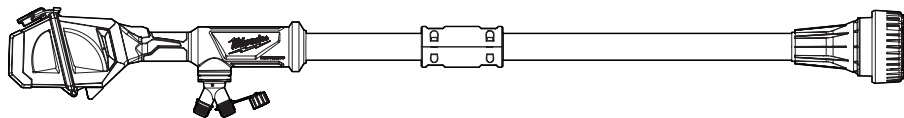



## OPERATOR'S MANUAL



Cat. No.  
**M18 BLSWP**

**M18™ STICK WATER PUMP**

 **WARNING**

 To reduce the risk of injury, user must read and understand operator's manual.

## GENERAL PUMP SAFETY WARNINGS

**WARNING** Read all safety warnings, instructions, illustrations and specifications provided with this pump. Failure to follow all instructions listed below may result in electric shock, fire and/or serious injury. Save all warnings and instructions for future reference.

### WORK AREA SAFETY

- **Keep work area clean and well lit.** Cluttered or dark areas invite accidents.
- **Do not operate pump in explosive atmospheres, such as in the presence of flammable liquids, gases or dust.** Motors create sparks which will ignite the dust or fumes.
- **Keep children and bystanders away while operating a pump.** Distractions can cause you to lose control.

### PERSONAL SAFETY

- **Stay alert, watch what you are doing and use common sense when operating pump.** Do not use pump while you are tired or under the influence of drugs, alcohol or medication. A moment of inattention while operating power tools may result in serious personal injury.
- **Use personal protective equipment. Always wear eye protection.** Protective equipment such as a dust mask, non-skid safety shoes, hard hat or hearing protection used for appropriate conditions will reduce personal injuries.
- **Prevent unintentional starting.** Ensure the switch is in the off-position before connecting to portable pump power base and/or battery pack, picking up or carrying the pump. Carrying pumps with your finger on the switch or energising power tools that have the switch on invites accidents.
- **Remove any adjusting key or wrench before turning the power tool on.** A wrench or a key left attached to a rotating part of the power tool may result in personal injury.
- **Do not overreach. Keep proper footing and balance at all times.** This enables better control of the power tool in unexpected situations.
- **Dress properly. Do not wear loose clothing or jewellery. Keep your hair and clothing away from moving parts.** Loose clothes, jewellery or long hair can be caught in moving parts.
- **Do not let familiarity gained from frequent use of pump allow you to become complacent and ignore tool safety principles.** A careless action can cause severe injury within a fraction of a second.

### PUMP USE AND CARE

- **Do not force the pump. Use the correct pump for your application.** The correct pump will do the job better and safer at the rate for which it was designed.
- **Do not use the pump if the switch does not turn it on and off.** Any pump that cannot be controlled with the switch is dangerous and must be repaired.
- **Remove the battery pack from the pump before making any adjustments, changing accessories, or storing.** Such preventive safety measures reduce the risk of starting the pump accidentally.

- **Store idle pump out of the reach of children and do not allow persons unfamiliar with the pump or these instructions to operate the pump.** Pumps are dangerous in the hands of untrained users.
- **Maintain pump and accessories.** Check for misalignment or binding of moving parts, breakage of parts and any other condition that may affect the pump's operation. If damaged, have the pump repaired before use. Many accidents are caused by poorly maintained pumps.
- **Use the pump, accessories and etc. in accordance with these instructions, taking into account the working conditions and the work to be performed.** Use of the pump for operations different from those intended could result in a hazardous situation.
- **Keep handles and grasping surfaces dry, clean and free from oil and grease.** Slippery handles and grasping surfaces do not allow for safe handling and control of the pump in unexpected situations.

### BATTERY TOOL USE AND CARE

- **Recharge only with the charger specified by the manufacturer.** A charger that is suitable for one type of battery pack may create a risk of fire when used with another battery pack.
  - **Use power tools only with specifically designated battery packs.** Use of any other battery packs may create a risk of injury and fire.
  - **When battery pack is not in use, keep it away from other metal objects, like paper clips, coins, keys, nails, screws or other small metal objects, that can make a connection from one terminal to another.** Shorting the battery terminals together may cause burns or a fire.
  - **Under abusive conditions, liquid may be ejected from the battery; avoid contact. If contact accidentally occurs, flush with water. If liquid contacts eyes, additionally seek medical help.** Liquid ejected from the battery may cause irritation or burns.
  - **Do not use a battery pack or tool that is damaged or modified.** Damaged or modified batteries may exhibit unpredictable behaviour resulting in fire, explosion or risk of injury.
  - **Do not expose a battery pack or tool to fire or excessive temperature.** Exposure to fire or temperature above 130°C (265°F) may cause explosion.
  - **Follow all charging instructions and do not charge the battery pack or tool outside the temperature range specified in the instructions.** Charging improperly or at temperatures outside the specified range may damage the battery and increase the risk of fire.
- ### SERVICE
- **Have your power tool serviced by a qualified repair person using only identical replacement parts.** This will ensure that the safety of the power tool is maintained.
  - **Never service damaged battery packs.** Service of battery packs should only be performed by the manufacturer or authorised service providers.

## SPECIFIC SAFETY RULES FOR PUMPS

**CAUTION** This pump has been evaluated for use with water only.

- Do NOT use in a flammable or explosive atmosphere. Do NOT pump brine, laundry discharge, or any other application which may contain caustic chemicals and/or foreign material. Do NOT pump fluids such as petrol, fuel oil, or kerosene.
- **WATER ONLY** - Do not pump gasoline or other flammable liquids.
- Not for potable water.
- Acceptable for indoor or outdoor use.
- Do not submerge handle or battery.
- Always use common sense and be cautious when using tools. It is not possible to anticipate every situation that could result in a dangerous outcome. Do not use this tool if you do not understand these operating instructions or you feel the work is beyond your capability; contact MILWAUKEE® Tool or a trained professional for additional information or training.
- Maintain labels and nameplates. These carry important information. If unreadable or missing, contact a MILWAUKEE® service facility for a replacement.

## ADDITIONAL BATTERY SAFETY RULES

**WARNING** To reduce the risk of fire, personal injury, and product damage due to a short circuit, never immerse your tool, battery pack or charger in fluid or allow a fluid to flow inside them. Corrosive or conductive fluids, such as seawater, certain industrial chemicals, and bleach or bleach-containing products, etc., can cause a short circuit.

**WARNING** Do not charge non-rechargeable batteries.

## SPECIFICATIONS

Cat. No.....	M18 BLSWP
Volts.....	18 V DC
Battery Type.....	M18™
Charger Type.....	M18™
Max Head Height.....	5 m
Max Flow Rate.....	94 LPM
Outlet size.....	32 mm (1 1/4") BSP Threaded
Hose fitting size.....	18 mm (3/4") x 2
Application	
Max Water Temperature.....	60°C (140°F)
Max Air Temperature.....	60°C (140°F)
HydroPass Filter Cat. No. ....	22-06-0604
Recommended Ambient	
Operating Temperature.....	-17°C to 51°C

## SYMBOLGY



Volts



Direct Current

**LPM**

Litres per Minute



Read operator's manual



Regulatory Compliance Mark (RCM). This product meets applicable regulatory requirements.



Do not dispose of electric tools together with household waste material. Electric tools and electronic equipment that have reached the end of their life must be collected separately and returned to an environmentally compatible recycling facility.

## FUNCTIONAL DESCRIPTION

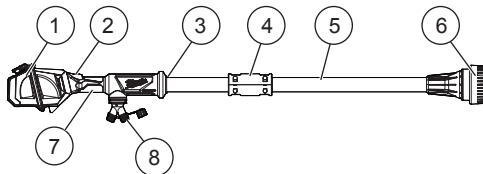

- |                    |                      |
|--------------------|----------------------|
| 1. Battery door    | 5. Lift tube         |
| 2. On/Off button   | 6. HydroPass™ filter |
| 3. Submersion line | 7. Handle support    |
| 4. Coupler         | 8. Hose fitting      |

## ASSEMBLY

**WARNING** Recharge only with the charger specified for the battery. For specific charging instructions, read the operator's manual supplied with your charger and battery.

### Inserting/Removing the Battery

To insert the battery, slide the pack into the body of the tool. Make sure it latches securely into place.

**WARNING** Only use accessories specifically recommended for this tool. Others may be hazardous.

To remove the battery, push in the release buttons and pull the battery pack away from the tool.

**WARNING** Always remove the battery pack any time the tool is not in use.

### Installing the Coupler

The coupler must be secured to connect the two halves before use. After initial assembly, keep coupler secured at all times.

**NOTICE** Do not remove the coupler after installation. Unexpected results or leaking could occur.

1. **WARNING** Remove battery to avoid starting the tool.
2. Remove the shipping oil fill cap.
3. Insert the end of each lift tube into the inner seal of the coupler. Adjust the electrical cord so that it curves to fit within the inner seal.
4. Align the connection point of the lift tubes with the guide ridges on the bottom half of the coupler.
5. Line up the screws on the top half of the coupler with the bottom half of the coupler. Enclose the connection point.
6. Use a size H5 (5 mm) hex key to securely tighten the four screws.

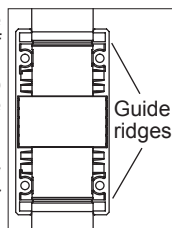
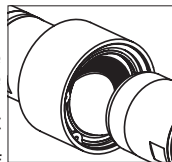

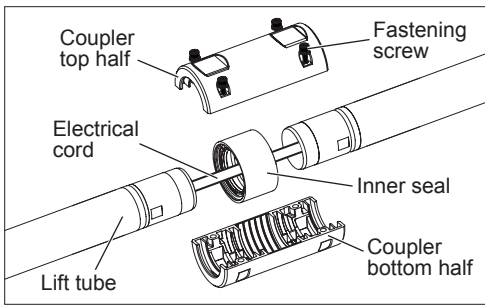

## OPERATION

**AWARNING** To reduce the risk of injury, always wear proper eye protection marked to comply with AS/NZS 1337.1.

### Operating the Pump

**AWARNING** Do NOT use in a flammable or explosive atmosphere. Do NOT pump brine, laundry discharge, or any other application which may contain caustic chemicals and/or foreign material. Do NOT pump fluids such as petrol, fuel oil, or kerosene.

This pump is designed for outdoor applications where water and organic debris (sticks, leaves, sand, gravel and soil) might be present. It can also be used with clean and salt water, but must be flushed out afterwards to avoid damaging the tool.

### Removing/Installing the Hose Fitting

1. **AWARNING** Remove battery to avoid starting the tool.
2. To **remove** the hose fitting, twist the fitting anticlockwise and pull it away from the rest of the tool.
3. To **install** the hose fitting, hand twist the fitting clockwise until it is fully connected with the rest of the tool. Do not overtighten.

### Connecting the Outlet Hose

- Use a hose with a 3/4"-11.5 BSPT fitting. To prevent leaking, ensure the hose has a properly-working o-ring in its fitting.
- For best results, a heavy duty hose should be used to prevent the hose from collapsing. Use a short length, large diameter hose, such as a 1.8 m long, 18 mm inner diameter garden hose. Longer or thinner hoses may reduce performance and flow rate.
- A regular garden hose may be used as an outlet hose.
- Make sure connections are tight.
- Hand thread the outlet hose onto the pump's hose fitting. Do not overtighten, or the threads may be damaged on the fitting or hose.

### Removing/Installing the HydroPass Filter

1. **AWARNING** Remove battery to avoid starting the tool.
2. To **remove** the HydroPass™ filter (Cat. No. 22-06-0604), use a T20 screwdriver to loosen the fastening screw. Twist the filter anticlockwise and pull it away from the rest of the tool.
3. To **install** the HydroPass™ filter, line the filter up at the end of the lift tube and hand twist the filter clockwise until it is fully connected with the rest of the tool. Do not overtighten. Use a T20 screwdriver to securely tighten the fastening screw.

**NOTE:** The HydroPass™ filter must be installed to use the pump.

1. **AWARNING** Remove battery to avoid starting the tool.

2. Ensure the HydroPass filter is properly installed. Do not operate without filter installed. Inspect the filter and keep it clean and free of all foreign objects.
3. Connect the hose to the pump.
4. Lay out the hose to ensure there are no blockages, kinks or bends. Take appropriate safety precautions to ensure the hose is secure for the worksite.
5. Place the HydroPass filter and lift tube below water surface, aiming as near as possible to the middle of the water source.

**AWARNING** Do not submerge the tool past the handle.

The pump will achieve best performance with the HydroPass filter as flat as possible and fully submerged in the water. The pump is not designed to sustain working in dry conditions. The pump will shutdown if working in dry conditions for a long period of time.

6. Insert battery pack.
7. Press and hold the power button to turn on the tool.
8. As soon as the pump begins to take in air or pumping is complete, turn off pump. To prevent backflow, remove the pump from the water before turning off.
9. Allow the liquid inside of the pump to drain out. If anything but clear water is accidentally pumped, flush with clear water for at least 30 seconds immediately after use.
10. Flush the pump with clear water immediately after use to prevent any damage to the tool.
11. Remove the battery and hose from the pump. Let pump and hose drain before storing.

## Troubleshooting

Problem	Cause	Correction
Pump will not run.	HydroPass™ filter is not attached.	See "Removing/Installing the HydroPass".
Flow rate is too low.	Hose is clogged or damaged.  HydroPass filter is clogged with debris.	Flush the hose, or replace the hose if damaged.  Clean the HydroPass filter.
Pump shutdown.	Dry pump shutdown.	Correct situation, then turn pump off, then back on to reset.
Over temperature shutdown	Blocked hose line. Hose line too high. Hose line too long. Pump ON for too long.	Correct situation, then turn pump off, then back on to reset.  Allow pump to cool.

## MAINTENANCE

**⚠WARNING** To reduce the risk of injury, always unplug the charger and remove the battery pack from the charger or tool before performing any maintenance. Never disassemble the battery pack, charger, or tool, except as provided in these instructions. Contact a MILWAUKEE® service facility for ALL repairs.

### Maintaining Tool

Keep your tool, battery pack and charger in good repair by adopting a regular maintenance program. Inspect your tool for issues such as undue noise, misalignment or binding of moving parts, breakage of parts, or any other condition that may affect the tool operation. Return the tool, battery pack, and charger to a MILWAUKEE® service facility for repair. After six months to one year, depending on use, return the tool, battery pack and charger to a MILWAUKEE® service facility for inspection.

If the tool does not start or operate at full power with a fully charged battery pack, clean the contacts on the battery pack. If the tool still does not work properly, return the tool, charger and battery pack, to a MILWAUKEE® service facility for repairs.

### Accidental Submersion

If the tool gets submerged past the handle:

1. Retrieve the tool out of the water and immediately remove the battery pack.
2. Lay the pump on a flat surface and allow to self-drain for 24 hours before using again.

### Storage

Never store with liquid inside the pump. To store the tool:

1. Flush the HydroPass filter and lift tube with clear water after use to prevent any damage to the tool.
2. Remove the hose and battery pack.

**⚠WARNING** To reduce the risk of personal injury and damage, never immerse a tool, battery pack or charger in liquid or allow a liquid to flow inside them.

### Cleaning

Clean dust and debris from vents. Keep handles clean, dry and free of oil or grease. Use only mild soap and a damp cloth to clean, since certain cleaning agents and solvents are harmful to plastics and other insulated parts. Some of these include petrol, turpentine, lacquer thinner, paint thinner, chlorinated cleaning solvents, ammonia and household detergents containing ammonia. Never use flammable or combustible solvents around tools.

## Repairs

For repairs, return the tool, battery pack and charger to the nearest authorised service centre.

## ACCESSORIES

**⚠WARNING** Use only recommended accessories. Others may be hazardous.

For a complete listing of accessories, go online to [milwaukeeetool.com.au](http://milwaukeeetool.com.au) / [milwaukeeetool.co.nz](http://milwaukeeetool.co.nz) or contact a distributor.





## **WARRANTY - AUSTRALIA and NEW ZEALAND**

Please refer to Australian and New Zealand warranty supplied with tool. This warranty applies only to product sold by authorised dealers in Australia and New Zealand.

## **SERVICE - AUSTRALIA and NEW ZEALAND**

**MILWAUKEE®** prides itself in producing a premium quality product that is Nothing But Heavy Duty™. Your satisfaction with our products is very important to us! If you encounter any problems with the operation of this tool, please contact your authorised **MILWAUKEE®** dealer.

For a list of **MILWAUKEE®** dealers, guarantee or service agents please contact **MILWAUKEE®** Customer Service or visit our website.

(Australia Toll Free Telephone Number 1300 645 928)

(New Zealand Toll Free Telephone Number 0800 645 928)

or visit [milwaukeetool.com.au](http://milwaukeetool.com.au)/[milwaukeetool.co.nz](http://milwaukeetool.co.nz).

### **Milwaukee Electric Tool Corporation**

13135 West Lisbon Road, Brookfield, Wisconsin U.S.A. 53005

#### **Milwaukee Tool (Australia)**

26 - 40 Nina Link, Dandenong South,  
Victoria, 3175, Australia

#### **Milwaukee Tool (New Zealand)**

274 Church Street, Penrose,  
Auckland, 1061, New Zealand

DESIGNED BY MILWAUKEE ELECTRIC TOOL CORP.